

Electrical Connection

AM1: one cable inlet for PG 13,5 Cable Gland

AM2: one cable inlet for 1/2" NPT Cable Gland

AM3: one cable inlet for PG11 Cable Gland

AM4: one cable inlet for M16 x 1,5 Cable Gland

AM5: one cable inlet for M20 x 1,5 Cable Gland



Operating Head Type

	F11 - Plain Metal plunger	F12 - Metal roller plunger	T14 - Metal plunger with dust protection cup
Conformity / (N.C. contact with positive opening operation)	EN 50047	EN 50047	EN 50047
Max actuation speed [m/s]	0,5	0,3	0,5
Min. force [N] or torque [Nm]: actuation / positive opening operation	15 / 30	12 / 30	15 / 30

Additional Technical Datas

		AM-F11Z11	AM-F12Z11	AM-T14Z11
Z11 Snap Action Contacts (1NO + 1NC)				
X11 Non overlapping Slow Action Contacts (1NO + 1NC)				
Y11 Overlapping Slow Action Contacts (1NO + 1NC)				
W02 Slow Action Contacts (2NC)				
W20 Slow Action Contacts (2NO)				
Z02 Snap Action Contacts (2NC)				
X12P Non overlapping Slow Action Contacts (1NO + 2NC)				
X21P Non overlapping Slow Action Contacts (2NO + 1NC)				
W03P Slow Action Contacts (3NC)				
Weight (packing per unit)	[kg]	0,180	0,190	0,165

Dimensions (in mm)

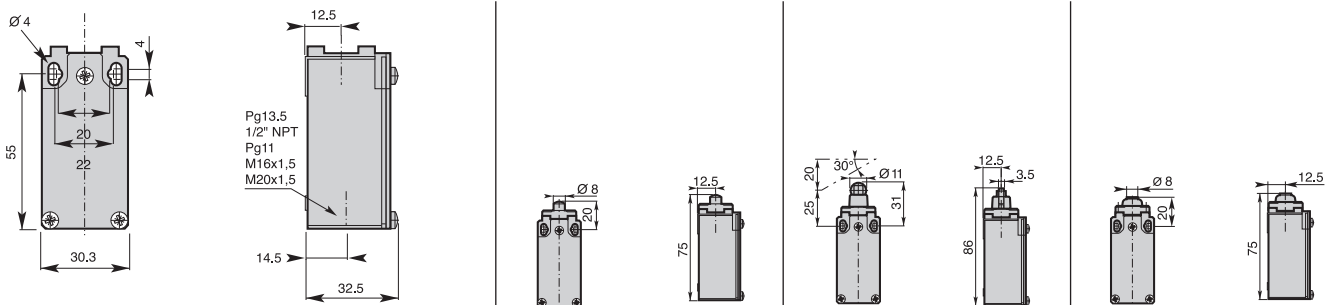



T3 - Plastic roller lever T30: on plastic plunger T31: on metal plunger	T3 - Plastic roller lever T32: on metal plunger T34: on plastic plunger	T38 - Adjustable plastic roller lever on metal plunger T39 - Same as above with dust protection cup	F4 - Ø 18 roller lever F41: nylon roller F43: metal roller	F42 - Ø 50 rubber roller lever
EN 50047 1,0 7/24	EN 50047 1,0 7/24	EN 50047 1,0 7/24	EN 50047 1,5 0,10 / 0,32	EN 50047 1,5 0,10 / 0,32

AM-T3-Z11 0 4,9 9,0 14,5 21,0 mm 21-22 13-14 21-22 13-14 21-22 13-14	AM-T3-Z11 0 4,9 9,0 14,5 21,0 mm 21-22 13-14 21-22 13-14 21-22 13-14	AM-T3-Z11 0 8,8 15,0 23,2 32,0 mm 21-22 13-14 21-22 13-14 21-22 13-14	AM-F4-Z11 0 17° 31° 47° 74° 21-22 13-14 21-22 13-14 21-22 13-14	AM-F42Z11 0 17° 31° 47° 74° 21-22 13-14 21-22 13-14 21-22 13-14
AM-T3-X11 0 6,0 10,5 21,0 mm 21-22 13-14 8,6	AM-T3-X11 0 6,0 10,5 21,0 mm 21-22 13-14 8,6	AM-T3-X11 0 10,6 18,5 32,0 mm 21-22 13-14 15,1	AM-F4-X11 0 21° 37° 74° 21-22 13-14 30°	AM-F42X11 0 21° 37° 74° 21-22 13-14 30°
AM-T3-Y11 0 10,2 14,6 21,0 mm 21-22 13-14 5,4	AM-T3-Y11 0 10,2 14,6 21,0 mm 21-22 13-14 5,4	AM-T3-Y11 0 16,8 25,1 32,0 mm 21-22 13-14 9,4	AM-F4-Y11 0 35° 51° 74° 21-22 13-14 18°	AM-F42Y11 0 35° 51° 74° 21-22 13-14 18°
AM-T3-W02 0 5,7 10,2 21,0 mm 11-12 21-22	AM-T3-W02 0 5,7 10,2 21,0 mm 11-12 21-22	AM-T3-W02 0 9,6 17,8 32,0 mm 11-12 21-22	AM-F4-W02 0 19° 37° 74° 11-12 21-22	AM-F42W02 0 19° 37° 74° 11-12 21-22
AM-T3-W20 0 5,3 21,0 mm 13-14 23-24	AM-T3-W20 0 5,3 21,0 mm 13-14 23-24	AM-T3-W20 0 9,2 32,0 mm 13-14 23-24	AM-F4-W20 0 18° 74° 13-14 23-24	AM-F42W20 0 18° 74° 13-14 23-24
AM-T3-Z02 0 5,1 8,6 13,1 21,0 mm 11-12 21-22 11-12 21-22	AM-T3-Z02 0 5,1 8,6 13,1 21,0 mm 11-12 21-22 11-12 21-22	AM-T3-Z02 0 8,8 14,6 22,8 32,0 mm 11-12 21-22 11-12 21-22	AM-F4-Z02 0 17° 30° 46° 74° 11-12 21-22 11-12 21-22	AM-F42Z02 0 17° 30° 46° 74° 11-12 21-22 11-12 21-22
AM-T3-X12P 0 6,8 11,8 21,0 mm 21-22 31-32 13-14 10,7	AM-T3-X12P 0 6,8 11,8 21,0 mm 21-22 31-32 13-14 10,7	AM-T3-X12P 0 11,9 19,7 32,0 mm 21-22 31-32 13-14 18,7	AM-F4-X12P 0 24° 40° 74° 21-22 31-32 13-14 38°	AM-F42X12P 0 24° 40° 74° 21-22 31-32 13-14 38°
AM-T3-X21P 0 6,8 11,8 21,0 mm 31-32 13-14 23-24 10,7	AM-T3-X21P 0 6,8 11,8 21,0 mm 31-32 13-14 23-24 10,7	AM-T3-X21P 0 11,9 19,7 32,0 mm 31-32 13-14 23-24 18,7	AM-F4-X21P 0 24° 40° 74° 31-32 13-14 23-24 38°	AM-F42X21P 0 24° 40° 74° 31-32 13-14 23-24 38°
AM-T3-W03P 0 6,8 11,8 21,0 mm 11-12 21-22 31-32 13-14 10,7	AM-T3-W03P 0 6,8 11,8 21,0 mm 11-12 21-22 31-32 13-14 10,7	AM-T3-W03P 0 11,9 19,7 32,0 mm 11-12 21-22 31-32 13-14 18,7	AM-F4-W03P 0 24° 40° 74° 11-12 21-22 31-32 13-14 38°	AM-F42W03P 0 24° 40° 74° 11-12 21-22 31-32 13-14 38°
0,170	0,175	0,175	0,235	0,255

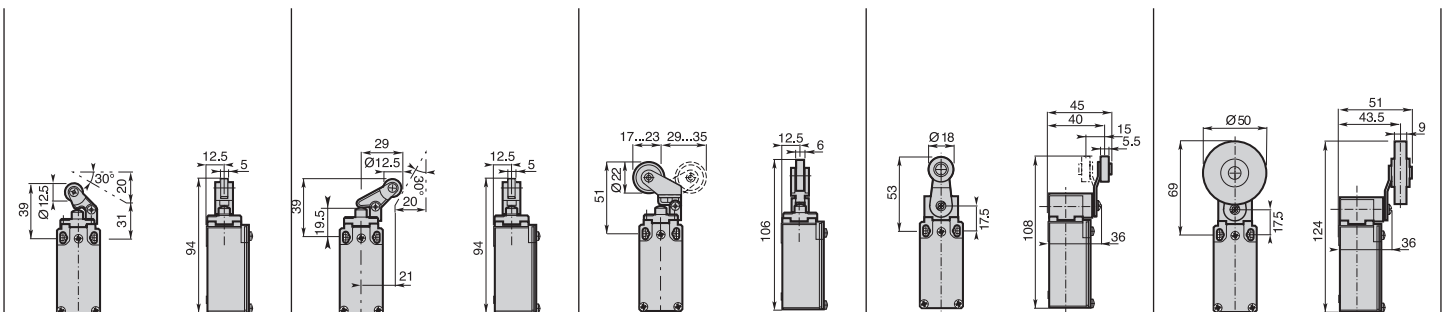

Electrical Connection

- AM1:** one cable inlet for PG 13,5 Cable Gland
- AM2:** one cable inlet for 1/2" NPT Cable Gland
- AM3:** one cable inlet for PG11 Cable Gland
- AM4:** one cable inlet for M16 x 1,5 Cable Gland
- AM5:** one cable inlet for M20 x 1,5 Cable Gland



Operating Head Type

	F4• - Ø 18 roller lever F45: nylon roller F46: metal roller	F5• - Adjustable lever with Ø 18 roller F51: nylon roller F53: metal roller	F52 - Adjustable Ø 50 rubber roller lever
Conformity /			
Max actuation speed [m/s]	1,5	1,5	1,5
Min. force [N] or torque [Nm]: actuation / positive opening operation	0,10 / 0,32	0,10 / 0,32	0,10 / 0,32

Additional Technical Datas

	AM•F4•Z11	AM•F5•Z11	AM•F52Z11
Z11 Snap Action Contacts (1NO + 1NC)			
X11 Non overlapping Slow Action Contacts (1NO + 1NC)			
Y11 Overlapping Slow Action Contacts (1NO + 1NC)			
W02 Slow Action Contacts (2NC)			
W20 Slow Action Contacts (2NO)			
Z02 Snap Action Contacts (2NC)			
X12P Non overlapping Slow Action Contacts (1NO + 2NC)			
X21P Non overlapping Slow Action Contacts (2NO + 1NC)			
W03P Slow Action Contacts (3NC)			
Weight (packing per unit)	[kg]	0,250	0,265

Dimensions (in mm)

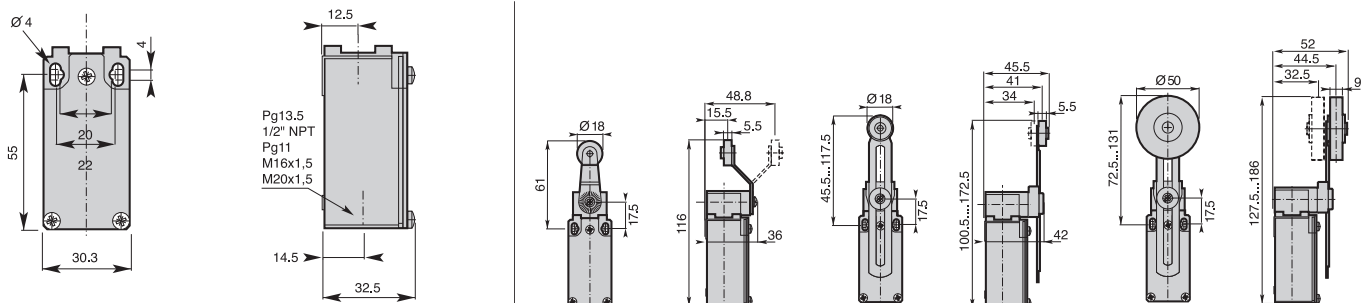



F55 - Adjustable lever with adjustable Ø 50 rubber roller

1,5
0,10 / 0,32

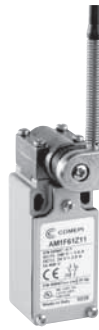

F61 - Nylon actuator with stainless steel spring

1,5
0,10 / -



F7 - Adjustable rod lever
F71: stainless steel rod Ø3
F72: fiberglass rod Ø3
F75: square steel rod 3x3

1,5
0,10 / 0,32



F7 - Adjustable Ø 6 rod lever
F73: nylon rod
F74: fiberglass rod

1,5
0,10 / 0,32



T91: Stainless steel spring multidirectional actuator

1,0
0,12 / -

 AM-F55Z11 0 17° 31° 47° 74° 21-22 13-14 21-22 13-14	 AM-F61Z11 0 17° 31° 74° 21-22 13-14 21-22 13-14	 AM-F7-Z11 0 17° 31° 47° 74° 21-22 13-14 21-22 13-14	 AM-F7-Z11 0 17° 31° 47° 74° 21-22 13-14 21-22 13-14	 AM-F91Z11 0 12° 23° 21-22 13-14 21-22 13-14
 AM-F55X11 0 21° 37° 74° 21-22 13-14 30°	 AM-F61X11 0 21° 74° 21-22 13-14 30°	 AM-F7-X11 0 21° 37° 74° 21-22 13-14 30°	 AM-F7-X11 0 21° 37° 74° 21-22 13-14 30°	 AM-F91X11 0 14° 21-22 13-14 21°
 AM-F55Y11 0 35° 51° 74° 21-22 13-14 18°	 AM-F61Y11 0 35° 74° 21-22 13-14 18°	 AM-F7-Y11 0 35° 51° 74° 21-22 13-14 18°	 AM-F7-Y11 0 35° 51° 74° 21-22 13-14 18°	 AM-F91Y11 0 25° 21-22 13-14 12°
 AM-F55W02 0 19° 37° 74° 11-12 21-22	 AM-F61W02 0 19° 74° 11-12 21-22	 AM-F7-W02 0 19° 37° 74° 11-12 21-22	 AM-F7-W02 0 19° 37° 74° 11-12 21-22	 AM-F91W02 0 14° 11-12 21-22
 AM-F55W20 0 18° 74° 13-14 23-24	 AM-F61W20 0 18° 74° 13-14 23-24	 AM-F7-W20 0 18° 74° 13-14 23-24	 AM-F7-W20 0 18° 74° 13-14 23-24	 AM-F91W20 0 13° 13-14 23-24
 AM-F55Z02 0 17° 30° 46° 74° 11-12 21-22 11-12 21-22	 AM-F61Z02 0 17° 30° 74° 11-12 21-22 11-12 21-22	 AM-F7-Z02 0 17° 30° 46° 74° 11-12 21-22 11-12 21-22	 AM-F7-Z02 0 17° 30° 46° 74° 11-12 21-22 11-12 21-22	 AM-F91Z02 0 12° 22° 11-12 21-22 11-12 21-22
 AM-F55X12P 0 24° 40° 74° 21-22 31-32 13-14 38°	 AM-F61X12P 0 24° 74° 21-22 31-32 13-14 38°	 AM-F7-X12P 0 24° 40° 74° 21-22 31-32 13-14 38°	 AM-F7-X12P 0 24° 40° 74° 21-22 31-32 13-14 38°	 AM-F91X12P 0 16° 21-22 31-32 13-14 26°
 AM-F55X21P 0 24° 40° 74° 31-32 13-14 23-24 38°	 AM-F61X21P 0 24° 74° 31-32 13-14 23-24 38°	 AM-F7-X21P 0 24° 40° 74° 31-32 13-14 23-24 38°	 AM-F7-X21P 0 24° 40° 74° 31-32 13-14 23-24 38°	 AM-F91X21P 0 16° 31-32 13-14 23-24 26°
 AM-F55W03P 0 24° 40° 74° 11-12 21-22 31-32 23-24 38°	 AM-F61W03P 0 24° 74° 11-12 21-22 31-32 23-24 38°	 AM-F7-W03P 0 24° 40° 74° 11-12 21-22 31-32 23-24 38°	 AM-F7-W03P 0 24° 40° 74° 11-12 21-22 31-32 23-24 38°	 AM-F91W03P 0 16° 11-12 21-22 31-32 23-24
0,265	0,245	0,245	0,255	0,175

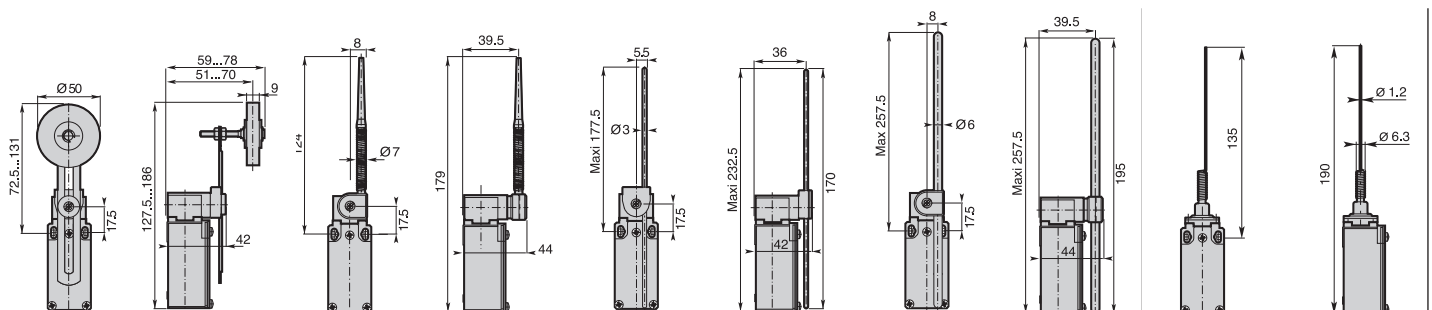

Electrical Connection

AM1: one cable inlet for PG 13,5 Cable Gland

AM2: one cable inlet for 1/2" NPT Cable Gland

AM3: one cable inlet for PG11 Cable Gland

AM4: one cable inlet for M16 x 1,5 Cable Gland

AM5: one cable inlet for M20 x 1,5 Cable Gland



Operating Head Type

T92: Multidirectional nylon actuator with stainless steel spring

T93: Stainless steel spring multidirectional actuator

T98: Pull action with ring

Conformity / (N.C. contact with positive opening operation)

Max actuation speed [m/s]

Min. force [N] or torque [Nm]: actuation / positive opening operation

1,0
0,12 / -

1,0
0,12 / -

0,5
30 / -

Additional Technical Datas

Order Code	Operation Diagram	AM-T92Z11	AM-T93Z11	AM-T98Z11A
Z11 Snap Action Contacts (1NO + 1NC)				
X11 Non overlapping Slow Action Contacts (1NO + 1NC)				
Y11 Overlapping Slow Action Contacts (1NO + 1NC)				
W02 Slow Action Contacts (2NC)				
W20 Slow Action Contacts (2NO)				
Z02 Snap Action Contacts (2NC)				
X12P Non overlapping Slow Action Contacts (1NO + 2NC)				
X21P Non overlapping Slow Action Contacts (2NO + 1NC)				
W03P Slow Action Contacts (3NC)				
Weight (packing per unit)	[kg]	0,180	0,185	0,210

Dimensions (in mm)

