

Utility knife with trapezoid blade

with metal body and 2-material handle, 3-positions adjustable blade, integrated cord-cutter and integrated blade-storage with 4 blades in the handle.

Cúter universal de lamas trapezoidales

con cuerpo metálico y mango bimatèrial, lama ajustable de 3 posiciones, cortacables integrado y 4 cuchillas de recambio dentro del mango.

Faca universal de lamina trapezoidal

com corpo de metal e punho em bimatéria, lâmina ajustável por 3 posições, corta fois incorporado, 4 laminas extra dentro do cabo.

Art.	L mm
3301	180

ergokraft

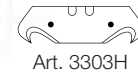
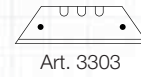

Jackknife with trapezoid blade

Ergonomic, non slip 2-component handle. Safety quick-release mechanism for the blade. Quick locking system of the blade-holder. Including 10 trapezoid blades with dispenser.

Cúter trapezoidal plegable

con mango ergonómico bimatèrial antideslizante. Mecanismo de seguridad para la extracción de la hoja. Sistema de fijación rápido de la hoja. Incluye 10 hojas trapezoidales con dispensador.

Faca com lâminas trapezoidais

cabo ergonómico de 2 componentes. Sistema de segurança na lâmina. Sistema de bloqueio do suporte de lâmina. Inclui 10 lâminas.

Art.	L mm
3304	155

ergokraft

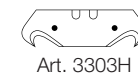
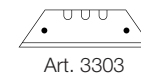

Universal safety cutter with trapezoid blade

Straight model with metal body and safety spring, which results in an automatic retension of the blade after releasing the button

Cúter universal de seguridad de lamas trapezoidales

Modelo recto con cuerpo metálico y mola de seguridad, para la retención automática de la lama después de soltar el botón.

Faca de segurança com lâminas trapezoidais

Modelo reto com corpo de metal e mola de segurança para retenção automática da lâmina depois de soltar o botão fine taglio

Art.	L mm
3302	150

Trapezoid blade set

for cutters 3301, 3302 and 3304. Dispenser with 5 pieces

Cuchillas trapezoidales de recambio

para cuters 3301, 3302 y 3304. Dispensador con 5 piezas

Juego de lâminas trapezoidais

para facas 3301, 3302 e 3304. Dispositivo com 5 peças

Art.	L mm	H mm
3303	65	19

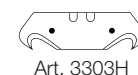
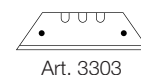
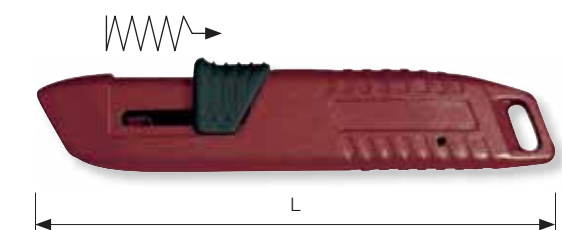

5
PCS

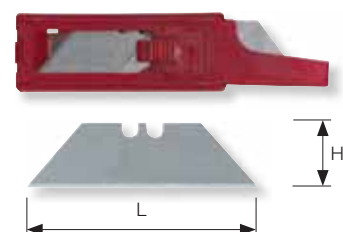

Hook blade set

for cutters 3301, 3302 and 3304. Dispenser with 5 pieces

Cuchillas de gancho de recambio

para cuters 3301, 3302 y 3304. Dispensador con 5 piezas

Jogo de lâminas trapezoidais gancho

para facas 3301, 3302 e 3304. Dispositivo com 5 peças

Art.	L mm	H mm
3303H	50	19

5
PCS

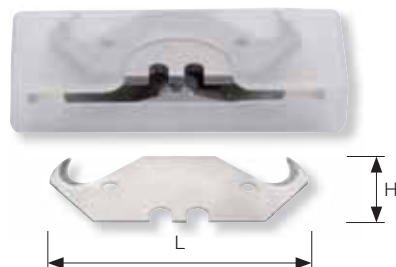

Snap-off cutter

Ergonomic ABS-handle with soft grip. Stainless steel blade guide, automatic blade locking system. Including 3 snap-off blades

Cúter universal de hoja fraccionable

Mango ergonómico ABS con agarre suave. Guía de la hoja de acero inoxidable, sistema automático de bloqueo de la hoja. Incluye 3 hojas de filos múltiples fraccionables.

X-acto

Corpo ergonômico ABS com grip macio. Guia de lâmina de aço inoxidável, sistema de bloqueio da lâmina automática. Incluindo 3 lâminas divisível

Art.	L mm
3310	135

Snap-off cutter

with solid metal body. Stainless steel blade guide, automatic blade locking system.

Cúter universal de hoja fraccionable

sólido de metal. Guía de la hoja de acero inoxidable, sistema automático de bloqueo de la hoja.

X-acto

Corpo metálico. Guia de lâmina de aço inoxidável, sistema de bloqueio da lâmina automática.

Art.	L mm
3317	130

Stainless steel snap-off cutter

with slim body, safety-lock and metal clip

Cúter universal en acero inoxidable

modelo fino, bloqueo automático de la hoja y clip de bolsillo.

X-acto de aço inoxidável

modelo plano com fecho segurança e clip de bolso

Art.	L mm
3311	129

ergokraft

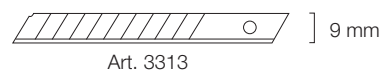

metallic

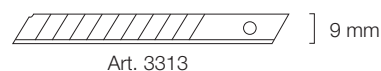

metallic

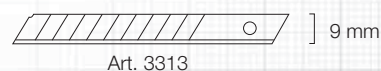

Spare snap-off-blades

with 12 segments per blade, 10 pieces in solid plastic case

Cuchillas separables de recambio

con 12 segmentos por cuchilla, 10 piezas en caja de almacenamiento

Lâminas divisível de reposição

com 12 segmentos por lâmina, 10 peças em caixa de armazenamento

Art.	L mm	H mm
3313	85	9

Snap-off cutter

Ergonomic ABS-handle with soft grip. Stainless steel blade guide, automatic snap off blade reloading and blade locking system. Including 3 spare snap-off blades

Cúter universal de hoja fraccionable

Mango ergonómico ABS con agarre suave. Guía de la hoja de acero inoxidable, sistema de recarga automática y de bloqueo de la hoja. Incluye 3 hojas de filos múltiples fraccionables de repuesto.

X-acto

Corpo ergonômico ABS com grip macio. Guia de lâmina de aço inoxidável, recarga automático e sistema de bloqueio da lâmina. Incluindo 3 lâminas de reposição divisível

Art.	L mm
3312	165

Snap-off cutter

Ergonomic ABS-handle with soft grip. Stainless steel blade guide, wheel blade lock. Including 6 snap-off blades

Cúter universal de hoja fraccionable

Mango ergonómico ABS con agarre suave. Guía de la hoja de acero inoxidable, bloqueo de la hoja de rueda selectora. Incluye 6 hojas de filos múltiples fraccionables.

X-acto

Corpo ergonômico ABS com grip macio. Guia de lâmina de aço inoxidável, roda de bloqueio da lâmina. Incluindo 6 lâminas divisível

Art.	L mm
3315	167

Snap-off cutter

with solid **metal** body. Stainless steel blade guide, automatic blade locking system.

Cúter universal de hoja fraccionable

sólido de **metal**. Guía de la hoja de acero inoxidable, sistema de bloqueo de la hoja automático.

X-acto

Corpo **métalico**. Guia de lâmina de aço inoxidável, sistema de bloqueio da lâmina automática.

Art.	L mm
3318	155

10
PCS



ergokraft

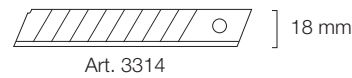

ergokraft

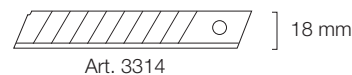

metallic



Spare snap-off-blades

with 7 segments per blade, 10 pieces in solid plastic case

Cuchillas separables de recambio

con 7 segmentos por cuchilla, 10 piezas en caja de almacenamiento

Lâminas divisível de reposição

com 7 segmentos por lâmina, 10 peças em caixa de armazenamento

Art.	L mm	H mm
3314	109	18

10
PCS



Foldaway knife

with mat finish high grade stainless steel blade, blade locking mechanism, aluminium handle and clip on the back

Navaja acero

con cuchilla inoxidable acabado mate, bloqueo de hoja, mango de aluminio y clip

Navalha universal

com acabamento mate em aço inox lamina de alta qualidade, mecanismo de bloqueio da lamina, cabo em aluminio e clip no verso

Art.	L1 mm	L2 mm
3323	112	188



Multiuse foldaway tool, set

Pliers with wire cutter, 8 functional tool-blades in the handles. Delivered with penknife in the same style and nylon belt carrying case.

Herramienta multiuso

plegable, con alicate cortante y 8 hojas de herramientas funcionales y en el mango. Suministrado con cuchillo de bolsillo en funda de nylon para cinturón.

Ferramenta multiusos

Alicate com corta fios, 8 laminas multifuncionais no cabo. Inclui navalha do mesmo estilo e bolsa de transporte em nylon

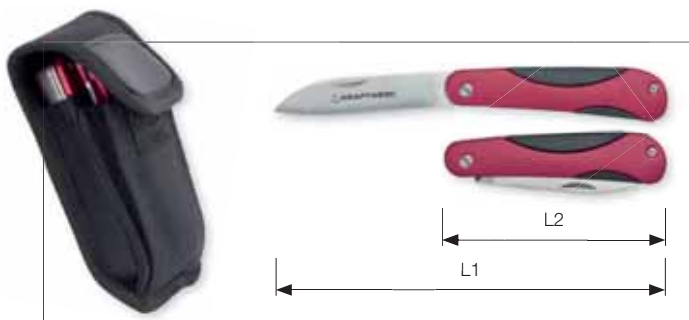

Art.	L1 mm	L2 mm	L3 mm	L4 mm
3322	188	112	100	160



Mini-multi-function tool with LED

Pliers with wire cutter, 4 functional tool-blades and mini-LED-light in the handles. Delivered with nylon belt carrying case

Mini-herramienta multifunción

plegable, con alicate cortante y 4 hojas de herramientas funcionales y mini-linterna en el mango. Suministrado en funda de nylon para cinturón.

Ferramenta multi-funções

Alicate com corta fios, 4 laminas multifuncionais no cabo e LeD. Inclui bolsa de transporte em nylon

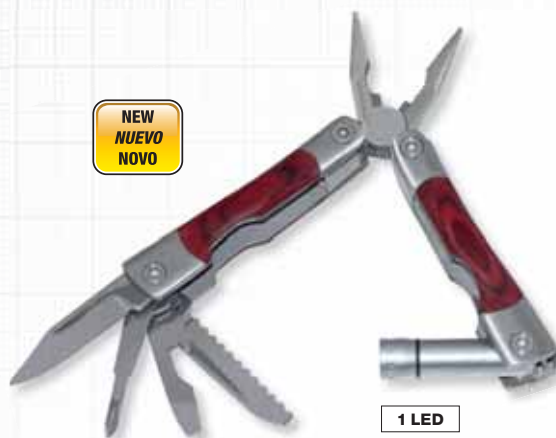

NEW
NUEVO
NOVO

1 LED

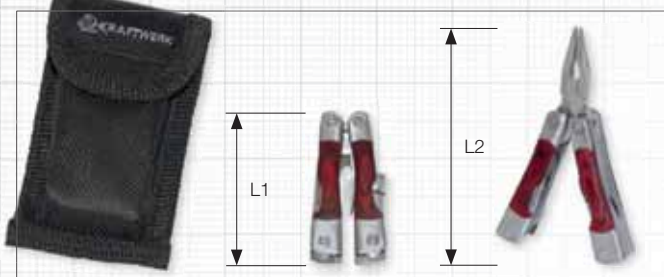

Art.	L1 mm	L2 mm
90157	68	108

Foldable electrician knife

Navaja de electricista

Navalha de electricista

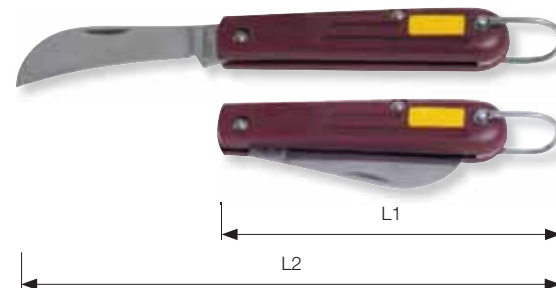

Art.	L1 mm	L2 mm
3321	95	160

Dismantling tool

especialmente suitable for larger cross-sections and for difficult insulating materials

Pelacable

especialmente adecuado para secciones mayores y materiales de aislamiento difíciles

Descarnador cabos

especialmente adequado para secções transversais maiores e para isolantes de difícil manuseio



Art.	∅ mm ²	L mm
2230	8 - 28	142

Pipe Cutter for plastic conduit pipes

Cortatubos para tubos de plástico

Corta tubos para tubos plásticos

PP, PE, PEX, PB, PVDF



Art.	∅ mm	∅ inch	L mm
5441	0 - 42	0 - 1-5/8	190

Spare blade

for art. 5441

Cuchilla de repuesto

para art. 5441

Laminas de reposiçio

para art. 5441

Art.	H mm	L mm
5441E	30	105



Mini tube cutter

for copper, brass, aluminium and thin walled steel pipes

Mini cortatubos

para cobre, bronce, aluminio, tuberías de acero con paredes finas

Mini corta tubos

para cobre, latão, alumínio, aço com paredes finas

Art.	∅ mm	L mm
5431	Cu/Al/Me 3 - 22	60



Cu/Al/Me
Art. 5440-1

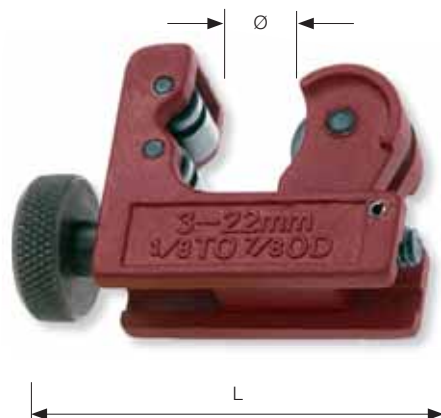

General tube cutter

for copper, brass, aluminium and thin walled steel pipes. Foldable internal deburrer

Cortatubos general

para cobre, bronce, aluminio, tuberías de acero con paredes finas. Desbarbador interno plegable.

Corta tubos universal

para cobre, bronce, aluminio, tuberías de acero con paredes finas. Desbarbador interno plegable

Art.	∅ mm	L mm
5432	Cu/Al/Me 3 - 32	150



Cu/Al/Me
Art. 5440-2

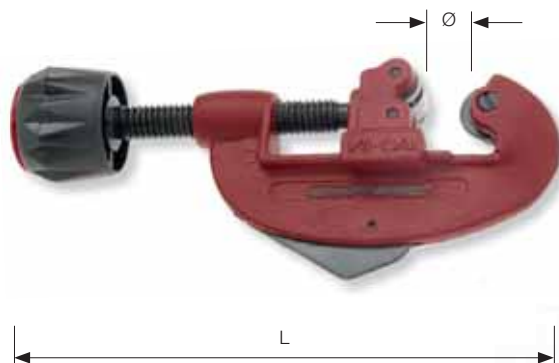

Mini tube cutter

Mini cortatubos

Mini corta tubos

Art.	∅ mm	L mm
5433	Cu/Al/Me 3 - 30	70
5435	Inox 3 - 30	70



Cu/Al/Me
Art. 5440-2



Inox
Art. 5440-4



Inox
Art. 5440-4ES

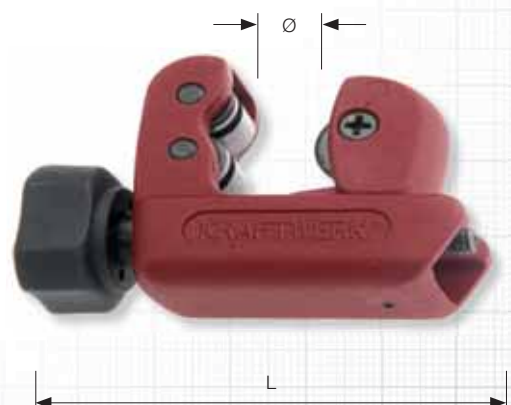

Telescope tube cutter
Cortatubos telescópico
Tagliatubi telescopico



Art.	Ø mm	L mm
5434	Cu/Al/Me 6 - 42	170
5436	Inox 6 - 42	170



Telescope tube cutter set

for copper, brass, aluminium and thin walled steel pipes. Precise working in confined spaces. Quick adjustment. Retractable internal pipe deburrer

Juego de cortatubos telescópico

para cobre, bronce, aluminio, tuberías de acero con paredes finas. Para trabajos precisos en espacios limitados. Ajuste rápido. Desbarbador retráctil integrado.

Jogo de corta tubos telescópico

para cobre, latão, alumínio, aço com paredes finas. Para trabalhos precisos e em locais de difícil acesso. Ajuste rápido. Limpa tubos retrátil

2
PCS



Art. 5434



Art. 5433

Art.	Ø mm	L mm
99025	Cu/Al/Me 3 - 30 (Art. 5433) 6 - 42 (Art. 5434)	70 170

Cutting wheel for tubing cutters

for copper, brass, aluminium and thin walled steel pipes

Cuchilla de repuesto para cortatubos

para cobre, bronce, aluminio, tuberías de acero con paredes finas

Lamina para corta tubo

6
PCS



Art. 5431

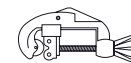
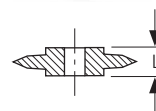

Art. 5432

Art.	Mat.	Ø mm	L mm
5440-1	Cu/Al/Me	18	2.9

Cutting wheel for tubing cutters
Cuchilla de repuesto para cortatubos
Lamina para corta tubos

Art.	Mat.	Ø mm	L mm
5440-2	Cu/Al/Me	18	4.8
5440-4	Inox	18	4.8

6
PCS



Art. 5433
Art. 5435

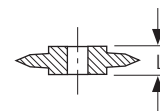

Cutting wheel for tubing cutters
Cuchilla de repuesto para cortatubos
Lamina para corta tubos

Art.	Mat.	Ø mm	L mm
5440-4ES	Inox	18	4.8

1
PC

NEW
NUEVO
NOVO



Art. 5433
Art. 5435

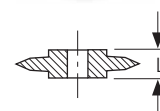

Cutting wheel for tubing cutters
Cuchilla de repuesto para cortatubos
Lamina para corta tubos

Art.	Mat.	Ø mm	L mm
5440-3	Cu/Al/Me	18	6.0
5440-5	Inox	18	6.0

6
PCS

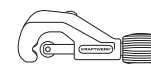

Art. 5434
Art. 5436

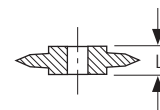

Cutting wheel for tubing cutters
Cuchilla de repuesto para cortatubos
Lamina para corta tubos

Art.	Mat.	Ø mm	L mm
5440-5ES	Inox	18	6.0

1
PC

NEW
NUEVO
NOVO

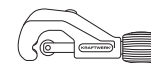

Art. 5434
Art. 5436

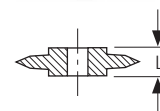

Reamer
for internal and external use

Escariador metal
para interior y exterior

Escareador tonelete
interior/exterior



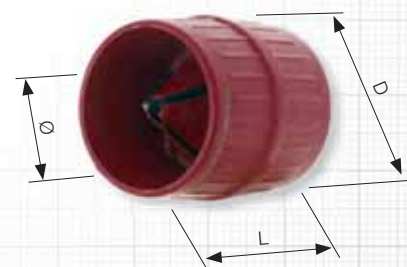

Art.	Ø mm	D mm	L mm
5470	6 - 40	52	55

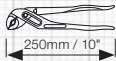
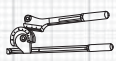

Plumbing tool set

Juego de herramientas para fontanería

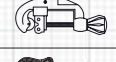
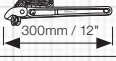
Jogo de ferramentas de canalizador

 250mm / 10"	Art. 2221-250	Ø 0 - 32 mm / 1-1/4"
	Art. 5451	C max. 180° Ø 1/4" / 5/16" / 3/8" CU / MS / AL
	Art. 5441	Ø 0 - 42 mm Ø 0 - 1-5/8"
 320mm / 12-1/2"	Art. 5406-320	Ø 0 - 42 mm Ø 0 - 1-5/8"
	Art. 5432	Ø 0 - 32 mm / CU
 300mm / 12"	Art. 5418-300	Ø 0 - 220 mm
	Art. 5431	Ø 0 - 22 mm / CU
	Art. 5470	Ø 6 - 40 mm

Art.	
99018	1



Handy Mini Scraper

Mini raspador práctico

Mini raspador Handy

Art.
3338
3338E Replacement Blades / Hojas de repuesto / Lâminas de reposição
3338B Replacement Plastic Blades / Hojas de repuesto en plástico / Lâminas de reposição de plástico



Universal scissors

Tijera universal

Tesoura universal

Art.	L mm
2240	185



Electrician's scissors

Tijera de electricista

Tesoura de electricista

Art.	L mm
2251	142



ergokraft



ergokraft



Compound action snips

left cut, with bi-material handles

Tijera articulada

de corte izquierda, mangos bimatériau

Tesoura articulada

de corte a esquerda, cabos bi-matériau

Art.	L mm	HRC	∠ MH mm	Inox 80kg/mm ² mm
2241	250	58-60	1.2	0.8

Compound action snips

right cut, with bi-material handles

Tijera articulada

de corte derecha, mangos bimatériau

Tesoura articulada

de corte a direito, cabos bi-matériau

Art.	L mm	HRC	∠ MH mm	Inox 80kg/mm ² mm
2242	250	58-60	1.2	0.8

Compound action snips

straight cut, with bi-material handles

Tijera articulada

de corte recta, mangos bimatériau

Tesoura articulada

de corte direito, cabos bi-matériau

Art.	L mm	HRC	∠ MH mm	Inox 80kg/mm ² mm
2243	250	58-60	1.2	0.8

Compound action snips set

Juego tijeras articuladas

Conjunto de tesouras articuladas

Art.	L mm	HRC	∠ MH mm	Inox 80kg/mm ² mm
2244	250	58-60	1.2	0.8



CrMo



ergokraft



CrMo



ergokraft



CrMo



ergokraft

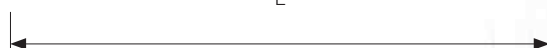

CrMo

3
PCS

ergokraft



Compound action offset snips

left cut, with bi-material handles

Tijera articulada de corte rectilíneo

de corte izquierda, mangos bimatériau

Tesoura articulada para cortes rectilíneos

de corte a esquerda, cabos bi-matériau

Art.	L mm	HRC	∠ MH mm	Inox 80kg/mm ² mm
2245	240	58-60	1.2	0.8

CrMo

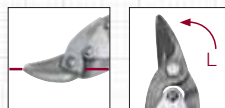

ergokraft



Compound action offset snips

right cut, with bi-material handles

Tijera articulada de corte rectilíneo

de corte derecha, mangos bimatériau

Tesoura articulada para cortes rectilíneos

de corte a direito, cabos bi-matériau

Art.	L mm	HRC	∠ MH mm	Inox 80kg/mm ² mm
2246	240	58-60	1.2	0.8

CrMo



ergokraft



Hacksaw frame

with HSS bi-metal saw blade, 2-component handle and quick-change blade device

Arco de sierra

con hoja de sierra en HSS bimetál, mango bimatériau y cambio rápido de la hoja

Serrote

com folha de serra HSS bimetál, punho de 2 componentes e sistema rápido de mudar a lamina

Art.	L1 mm	L2 mm
3305	300	400

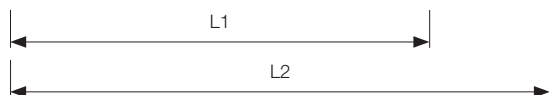

Art. 3316

Industrial hacksaw frame

with HSS bi-metal saw blade, ergonomic 2-component handle and quick-change blade device.

Arco de sierra industrial

con hoja de sierra en HSS bimetál, mangos bimatériauales y cambio rápido de la hoja

Serrote industrial

com folha de serra HSS bimetál, punhos ergonomicos de 2 componentes e sistema rápido de mudar a lamina

Art.	L1 mm	L2 mm
3306	300	403



ergokraft

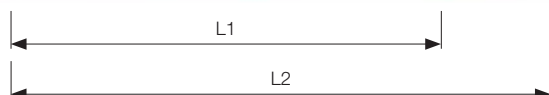

Art. 3316

Straight hacksaw blade holder

with 2-component handle

Mango sierra

bimaterial

Serrote punho direito

de 2 componentes

Art.	L1 mm	L2 mm
3308-1	163	315

 Art. 3316

Straight hacksaw blade holder

in aluminium

Mango sierra

en aluminio

Serrote punho direito

em alluminio



Art.	L1 mm	L2 mm
3308-2	205	324

 Art. 3316

Hacksaw blade

Hoja de sierra

Folha de serra

Art.	L mm	 /cm	 /"
3316-18	300	7	18
3316-24	300	10	24
3316-32	300	13	32

Mini hacksaw frame

Arco de sierra mini

Mini serrote Junior

Art.	L1 mm	L2 mm
3309	150	250

 Art. 3319

Hacksaw blade for mini hacksaw

Hoja de sierra mini

Folha de serra mini

Art.	L mm	 /cm	 /"
3319	150	10	24

ergokraft



DIN 6450C

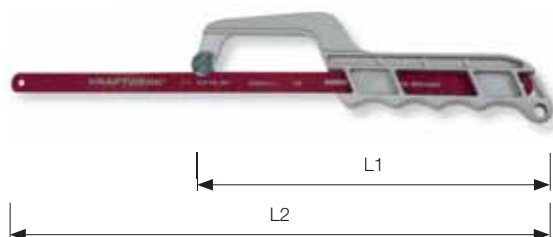

DIN 6494 / ISO 2336-1

